

ADAPT



Design for the Changing Workplace





TABLE OF CONTENTS

1

HELP

How can JCI Help
you and your clients?

2

PLAN

Space Planning for Future
and Existing Tenants

3

SOLUTIONS

Space Solutions for
Common Areas

4

AIR

Solutions for Building Air
Quality

5

VIRTUAL

Virtual Tours: 3D Real
Estate

6

TOOLS

Tools to reduce shared
touchpoints

7

GREETINGS

Greetings from 2020

8

RESOURCES



HOW CAN JCI HELP YOU AND YOUR CLIENTS?

With the changing world around us, there is no surprise that office buildings and tenant office space must change and adapt as well. At JCI, we strive every day to make the best office space to fit our clients needs. Those needs now include health safety of buildings and the tenants and visitors who visit them each day. JCI is here to help our clients adapt.

JCI SAFE WORKPLACE CONSULTING INCLUDES:

1

SPACE PLANNING
SOLUTIONS FOR TENANT
SPACE IMPROVEMENTS TO
MEET CURRENT CDC
GUIDELINES

2

SAFETY CONSULTING AND
EVALUATIONS OF EXISTING
BUILDING COMMON AREAS

3

COMPREHENSIVE SAFE
WORKSPACE PLAN



PLAN WILL INCLUDE THE FOLLOWING:

- ALTERATIONS TO PLAN TO ACCOMMODATE NEW GUIDELINES INCLUDING FURNITURE LAYOUT AND CORRIDOR/AISLE WIDTH ADJUSTMENTS
- ANALYZE SQUARE FOOT PER PERSON REQUIREMENTS
- PROVIDE COLOR CODED ZONES
- SAFETY AND SANITATION SOLUTIONS
- SYMBOL AND LEGENDS FOR EASY IDENTIFICATION
- AUTOMATIC AND TOUCHLESS FIXTURE RECOMMENDATIONS
- AIR QUALITY RECOMMENDATIONS
- TOUCHLESS/AUTOMATIC DOOR AND ELEVATOR SOLUTIONS



SPACE PLANNING FOR FUTURE AND EXISTING TENANTS

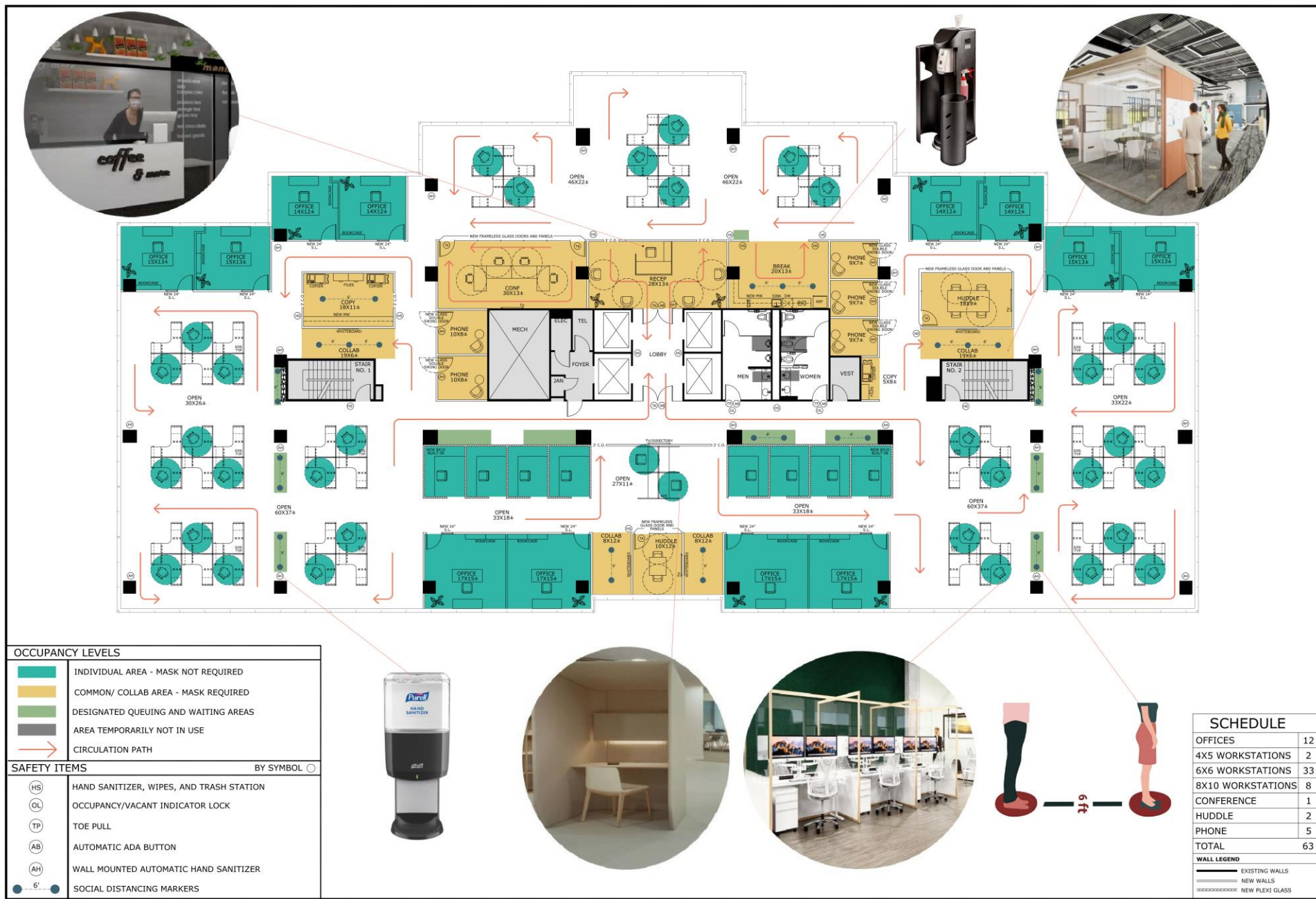

SPACE SOLUTIONS FOR BUILDING COMMON AREAS

RECEPTION/LOBBY

- Remove unnecessary furniture that does not allow for proper social distancing and/or provide new furniture that allows dividers/space between visitors.
- Provide plexiglass or non-absorbent dividers at reception desks and between furniture.
- Sanitizing stations at entry and exit points.
- Incorporate flooring markers and use wayfinding solutions to direct visitors in lobby areas as well as inside elevators.

ELEVATORS

- Provide floor signage and note distance of riders.
- Provide signage regarding occupancy load of cabs.

CONFERENCE CENTER/TOWN HALL

- Remove furniture and space remaining furniture to allow for proper social distancing.
- Consider dividing large conference rooms into multiple smaller meeting rooms.
- Look into providing open area or outdoor meeting spaces in lieu of closed rooms.
- Control access to these spaces with a mobile phone app.

DINING/CAFÉ

- Remove furniture that is unnecessary and does not allow for proper social distancing.
- Rearrange the existing furniture or purchase new.
 - i.e. include more (2) top tables in lieu of larger tables.
- Open up the dining room entry points.
 - Remove doors or install automatic doors.
- Controlling the traffic and monitor occupancy and/or time allowed per person.
- Provide outdoor seating areas.
- Offer more prepackaged food and/or cut back the menu.
- Order food via phone apps for pickup and payment.
- Close/remove self serve areas (salad bars, dispensers, vending).



SPACE SOLUTIONS FOR BUILDING COMMON AREAS



FITNESS CENTER

- Remove equipment that does not allow for proper social distancing.
- Spread out the existing equipment and allow for more circulation.
- Consider purchasing multi-use equipment in lieu of single-use equipment to reduce the amount of machines that are used by each person.
- Controlling traffic and density in a fitness center with occupancy indicators and signage.
- Provide outdoor workout spaces.
- Adjusting the hours of operation to limit and monitor accessibility.
- Encourage users to bring their own workout accessories and water bottles in lieu of utilizing the building's equipment.
- Provide additional sanitizing stations and associated trash cans.
- Provide signage and new set standards for Fitness Center usage. Masks must be worn at all times.
- Verify HVAC/Ventilation has proper air flow to keep air moving.
- Provide automatic touchless fixtures throughout.
- Add Touchless door openers to all doors.

RESTROOMS

- Install automatic touchless doors openers or toe door openers.
- Provide wipes and towels near entry and exit points along with associated trash cans
- Update fixtures to automatic in lieu of manual where possible.
 - Automatic paper towels have been shown to spread less germs than automatic hand dryers.
- Post signage and/or reminders regarding recommended hand washing, sanitizing, and cleaning procedures.
- Limit the occupancy allowed in a restroom with occupancy indicators.
- Consider ways to improve the air quality and ventilation in the restroom.
- Utilize existing single-user restrooms or look into providing more single user options.
- Close off every other stall to minimize occupancy and proximity to others.
- Provide taller and wider privacy screens at urinals and stalls.



SPACE PLANNING FOR COMMON AREAS

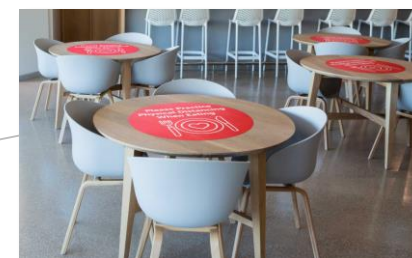
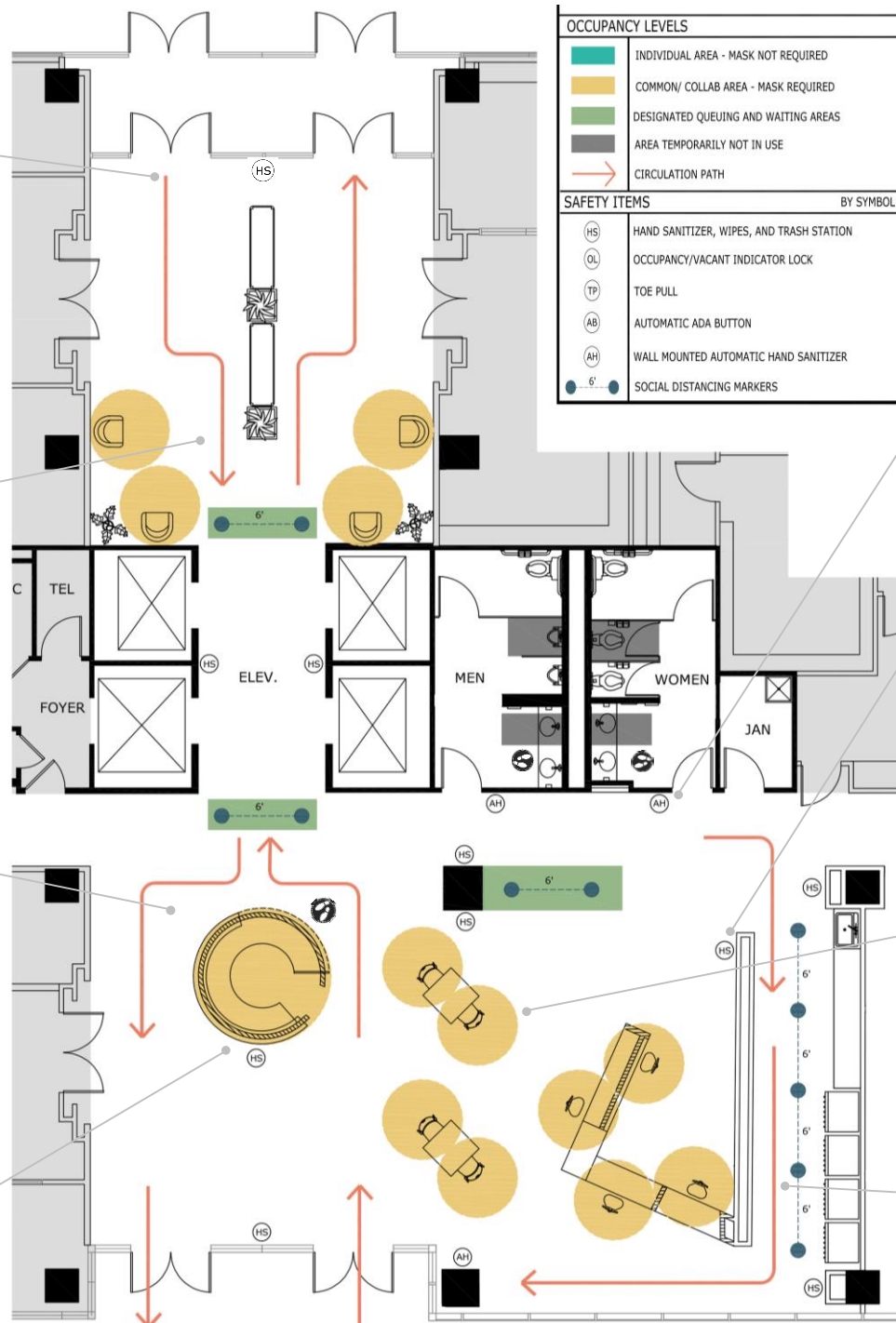
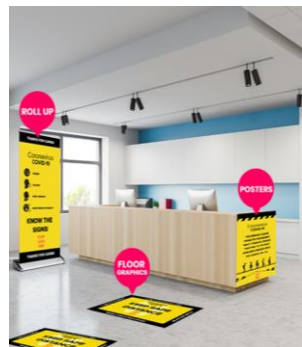

BUILDING SYSTEMS – HVAC and VENTILATION

- Verify building air quality and considers upgrades.
- Provide more frequent air filter changes.
- Biophilia: Install Living / Green walls to improve air quality.
- Update mechanical systems and new technology for better air quality.
- Consider Adding/Updating Air Quality with one of the below Sanitizing solutions
 - UV Air Sanitizer System - Kills up to 99% of bacteria, mold and viruses
<https://teamenoch.com/hvac/uv-hvac-filters/>
 - Plasma Air - Unit that eliminates bacteria in the air - <https://blog.plasma-air.com/plasma-air-kills-airborne-viruses-cleaning-the-air-you-breathe/>



Living “Green” Wall



UV Air Sanitizer

Plasma Air Unit – How It Works

How Bipolar Ionization Works to Clean the Air of Pollutants

Much like sunlight does in the atmosphere, Plasma Air technology produces a natural bio-climate rich in positive and negative oxygen ions. The negative ions contain an extra electron while the positive ions are missing an electron resulting in an unstable condition. In an effort to restabilize, these bipolar ions seek out atoms and molecules in the air to trade electrons with, effectively neutralizing particulate matter, bacteria and virus cells, odorous gases and aerosols, and VOCs.

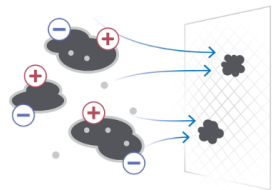

Airborne particles are charged by the ions causing them to cluster and be caught in filters

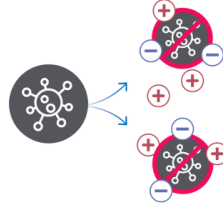

As they divide to reproduce, bacteria and virus cells bond with oxygen ions and are destroyed



Odorous gases and aerosols oxidize on contact with oxygen ions and are neutralized

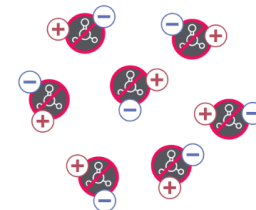

Oxygen ions cause a chemical reaction with VOCs breaking down their molecular structure

VIRTUAL TOURS: 3D REAL ESTATE

How it Works:

- Do a walk-through of the space as if you were physically moving room-to-room and experience it as if you were there.
- Instantly get a bird's eye view of the space, looking down from above as if the roof were removed so you can easily understand the layout of the property.
- Annotate features of the space by placing tags anywhere, such as notes, videos, and photos. Help guide viewers to what they need to see.
- Matterport's 3D virtual tours can reach a wider audience while maintaining social distancing protocols.



Mattertags™

Embed annotations and media in your digital twin to highlight key features of your property.



Schematic Floor Plans

Generate schematic floor plans of your property with the push of a button.



Measurements

Measure any aspect of your space, such as walls, windows, furniture, and more.



High Definition Photos

4K print quality photography automatically generated; or choose your own (only with Pro2 Camera)



MatterPak™

A bundle of digital assets you can download, edit, and import into 3rd party programs.



Guided Tours

Automatically generate video tours that highlight the attributes of your space.



ajci.com

TOOLS TO REDUCE SHARED TOUCHPOINTS

AUTOMATIC FIXTURES



- Automatic sanitizer dispensers.
- Automatic hand soap dispensers
- Automatic faucets
- Automatic hand dryer
- Automatic paper towel dispensers
- Automatic flush valves



HANDS-FREE DEVICES



- Foot Door Openers
- "Clean Key" Tools.
- Hands Free Arm Opener
- Motion Sensor Touchless Trash Receptacle

TOUCHLESS UV DEVICES



- Disinfects Cellphone, Tables, and other mobile devices in 30 seconds.

TECHNOLOGY



- Touchless door openers
- Voice activated touchless conference equipment
- Smart Technology such as:
 - Touchless biometric systems for security, facial recognition, and temperature detection
 - Ultra sonic data-transmission technology for touchless elevator and security control



- Did you know that handshakes date back to 5 B.C. in Greece. Back then it was a symbol of peace. In medieval Europe, Knights would put out their right hand to show they were not reaching for their swords. The up-and-down movement would then shake free any weapons hidden up a sleeve.
- To date, the handshake is one of the most widespread greetings around the world, though in current times the handshake is “on hold”.
- Scientists say that we should nix the handshake altogether. Why? Because 90% of germs are transmitted from one hand to another during a shake.
- Many experts do not feel Americans will change their ways long term and expect shaking hands to resurface, but this time with a more meaningful relationship. Shaking hands in the future will be more of a “I really trust you” and will be considered more personable.
- What should we do right now?
 - For now the most powerful thing we can do is direct eye contact.
 - You may also see some elbow bumping and head nods. Check out ‘WORKEST’ Handshake Alternatives and start a new trend with one of these →



<https://www.forbes.com/sites/reginacole/2020/04/17/five-ways-covid-19-is-changing-the-future-of-interior-design/#6a5b73602ee2>
<https://www.multiphasingnews.com/post/fitness-center-amenities-faq-during-covid-19/>
<https://www.marketwatch.com/story/the-cafeteria-and-other-parts-of-office-life-will-change-dramatically-after-coronavirus-2020-05-04>
<https://www.bloomberg.com/news/articles/2020-04-17/coronavirus-shutdown-how-to-reopen-offices-cafes-around-world>
<https://www.workdesign.com/2020/04/a-common-sense-guide-for-the-return-to-the-office/>
<https://slate.com/business/2020/05/bathrooms-coronavirus-work-reopen.html>
<https://www.forbes.com/sites/danestangler/2020/04/03/here-are-three-reasons-covid-19-makes-coworking-spaces-even-more-important/#35a0a36333ac>
<https://gcuc.co/7-reasons-covid-19-will-not-be-the-downfall-of-coworking/>
https://www.wework.com/info/navigating-the-future-of-the-workplace?campaign_sfid=70121000001hyVBQAY
<https://technical.ly/dc/2020/05/20/how-5-dc-coworking-spaces-plan-to-reopen-post-pandemic-coronavirus-alley-wework-makeoffices-in3dc-1776/>
<https://www.cdc.gov/coronavirus/2019-ncov/community/guidance-business-response.html>
<https://www.e-arc.com/blog/4-tools-that-can-help-you-safely-bring-employees-back-to-the-office/>
<https://www.cushmanwakefield.com/en/netherlands/six-feet-office>
<https://loftwall.com/gallery/>
<https://www.gensler.com/research-insight/blog/designing-office-building-lobbies-to-respond-to-coronavirus>
https://9afc4921-8e75-4675-ba7f-c5fcf5d7bf7d.filesusr.com/ugd/18f191_a45d86f1c74647f188f8a2001d95bff6.pdf
<https://www.nytimes.com/2020/05/04/health/coronavirus-office-makeover.html>
<https://hughesmarino.com/blog/2020/05/04/8-practical-steps-for-a-safer-office-environment/>
<https://www.marketwatch.com/story/the-cafeteria-and-other-parts-of-office-life-will-change-dramatically-after-coronavirus-2020-05-04>
<https://www.cnn.com/2020/04/27/after-coronavirus-the-office-of-the-future-is-the-office-of-the-past.html>
<https://www.corgan.com/story/bridge-to-the-new-normal-transitioning-back-to-the-workplace/>
<https://www.interiordesign.net/articles/17888-designers-and-architects-find-new-ways-to-adapt/>
<https://www.interiordesign.net/articles/17888-designers-and-architects-find-new-ways-to-adapt/>
https://www.wsj.com/articles/when-its-time-to-go-back-to-the-office-will-it-still-be-there-11589601618?emailToken=991a605824de561df07c1fd7f48bfc5fQrAh/muwhhn1Mo+FyUsDYGSw7edG3KZYEOEjzwt+PXjfMgGWz8I3aNIKTKKOGGbrsR5RVNd/GIKQ1AQm2chGKM31c1uIYZOZOUFVtJe+9r3a+ilkP3UUZ9AnLOpf5A2&reflink=article_email_share
<https://www.osha.gov/Publications/OSHA3990.pdf>
<https://www.ctvnews.ca/health/coronavirus/new-normal-will-covid-19-mark-the-death-of-the-handshake-1.4895157>
<https://newsnetwork.mayoclinic.org/discussion/is-covid-19-the-end-of-the-handshake-as-we-know-it/>
<https://www.vox.com/recode/2020/4/14/21211789/coronavirus-office-space-work-from-home-design-architecture-real-estate>
<https://www.cdc.gov/coronavirus/2019-ncov/community/guidance-business-response.html>
<https://www.grainger.com/product/ESSEX-Touchless-Switch-32NF31>
<https://www.bobrick.com/products/washroom-accessories/restroom-accessories-catalog/soap-dispensers-wall-mounted/product/b-2013/?>
<https://www.elkay.com/products/lkb721c.html>
https://www.us.kohler.com/us/browse/bathroom-commercial-bathroom-commercial-faucets/_/N-25ag
<https://www.cureuv.com/products/handheld-uv-sterilizer-wand>
https://www.lockncharge.com/products/uvone/?gclid=CjwKCAjw_LL2BRakEiwAv2Y3SavTJoLmfTdC5qSPc2I2lr1wGyADbMVymNXIBXpNDRKIF7Cf5HrgaRoCRHUQAvD_BwE
<https://beward.en.alibaba.com/product/62495877848-811411819/Touchless Biometrics Body Temperature detection measure time attendance machine face recognition device for turnstile.html>
<https://wedc.org/wp-content/uploads/2020/05/COVID-19-Gyms-and-Fitness-Facilities-Guidelines.pdf>
<https://wedc.org/wp-content/uploads/2020/05/COVID-19-Gyms-and-Fitness-Facilities-Guidelines.pdf>
<https://www.comunicaffe.com/starbucks-korea-limits-seating-in-social-distancing-campaign-against-coronavirus/https://www.bbc.com/future/article/20200527-coronavirus-how-covid-19-could-redesign-our-world>

